

NMG NIPRAS
METAL GROUP

شركة مجموعة نبراس المعادن المحدودة
NIPRAS METAL GROUP COMPANY Ltd.

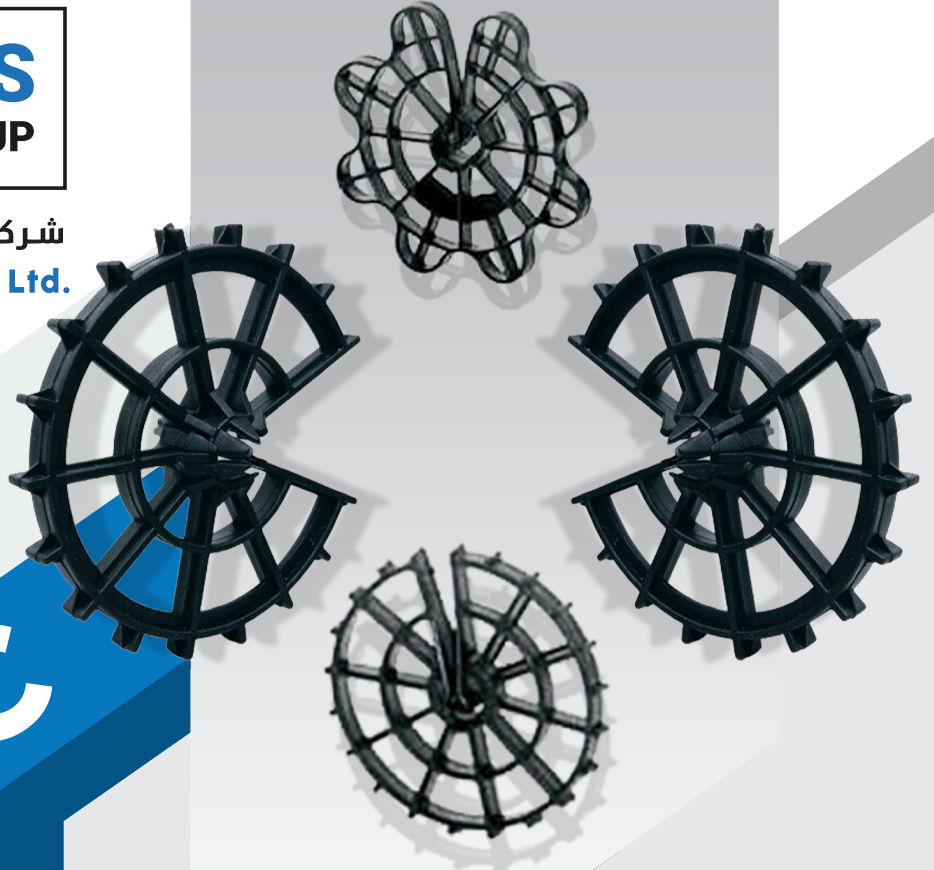

PLASTIC SPACER DATASHEET



رؤية
2030
المملكة العربية السعودية
KINGDOM OF SAUDI ARABIA





شركة نبراس المعدن للصناعة NIPRAS METAL INDUSTRY Co.

Introduction

NIPRAS METAL GROUP (NMG)

- Established in the year 2010 with high quality Manufacturing & Trading expertise with 3 companies under the umbrella -

1. NIPRAS METAL INDUSTRY COMPANY (NMIC)
2. NIPRAS METAL TRADING COMPANY (NMTC)
3. NIPRAS METAL CONTRACTING Est. (NMCE)

We are a Saudi based company with our team in major cities across the kingdom with our headquarters in RIYADH providing the best & professional solutions in construction & architectural industry. Intuitive creativity, precise technical assistance and reputed interest in our client marked us as one of the leading Industries throughout the KINGDOM and other GCC countries.

We have a plan to build the successful businesses for today's economy. We aim at manufacturing our products to not only have a beautiful appearance, but also that the customers perceive something of great intrinsic value when they touch it. We constantly strive to create future products that will stimulate the customer's senses to bring about joy and excitement each time the product is used.

Our success will be validated when the end users use the product and "their heart leaps for joy" and "they are deeply moved". We will create a future without limits through valued manufacturing. We will be responsible for planning, development, and manufacturing and be considered as the only manufacturer of its kind. We have earned great respect as a manufacturer and trader by serving the best to our valued customers.

1. Accountability

We accept responsibility for our work products and services. Upholding the highest standards evaluating for measuring our results against stated performance for our work with relevance, credibility and timelessness.

2. Teamwork

Our success depends on working together and fostering an inclusive and mutually supportive environment.

Our work-friendly for environment encourages collaboration, innovation, flexibility and figure the integration of resources.



Our Strength Factors

3. Communication

We clarify expectations up front and communicate openly, honestly and accurately. We look for ways to improve our ways and for our work products by seeking giving and use both praise and constructive feedback.

4. Respect

We promote diversity and equal opportunity throughout other organizations. We value and respect the views of our clients.



PLASTIC SPACER

NMTC Plastic Spacers are used for horizontal reinforcements such as suspended slabs, beams, etc. and offer good stability. The concave seat accommodates steel diameters of 6-40mm. The design of the NMTE Plastic Spacer does not obstruct concrete flow. Use approximately 2-4m²

Plastic spacers are a cost-effective alternative to the tried and tested fibre-reinforced concrete spacers and to spacers made of cast concrete.



Characteristics/Advantages

- High strength up to 4 KN
- Manufactured from Recycled High-Density Polypropylene
- Designed with recess to support Reinforcing
- Designed to allow maximum flow of concrete
- Designed with hooks to secure Binding Wire
- Suitable for Reinforcing from 6 - 40mm
- Larger Covers (60 - 100mm) are made with a wider base
- Quick and Easy to Install

Typical Uses

- Reinforcement
- All types of applications on site or in the pre-cast concrete yard
- Suitable for most reinforcing applications
- Quick and Easy to Install

TECHNICAL DATA FOR PLASTIC SPACER

Chairs and Wheel

To achieve the required cover to reinforcing steel according to BS 7973-1-2001, QCS 2010 Section 5 Part 11.5.7 and Part 11.5.8 and ACI SP-66, chairs or wheels must be used according to a standard method of application. The spacers supplied by NMTE are of the plastic “clip on” type, in wheel or chair form. Spacers are available to give cover to a range of bars in nominal steps, typically 20, 25, 30, 40, 60, 65 and 75mm. **Plastic Chair Spacers MC** are used for spacing of lower reinforcing in slabs and beams and classified under category (L).

Plastic Chair Normfix are used for spacing heavy reinforcing steel in slabs and beams and classified under category (H). **The MW wheel spacers** are for vertical reinforcing steel in walls and columns.

To ensure the correct positioning of the steel, spacers must be placed according to the recommended pattern and the load capacity of the individual chair at the allowable deflection, point load per spacer:

MC=0.40 KN – Normfix: 6 KN – MW =0.60 KN

Spacers are marked with type, concrete cover, and bar size range.

CHAIR SPACING FOR SLAB CONSTRUCTION (d = bar diameter)

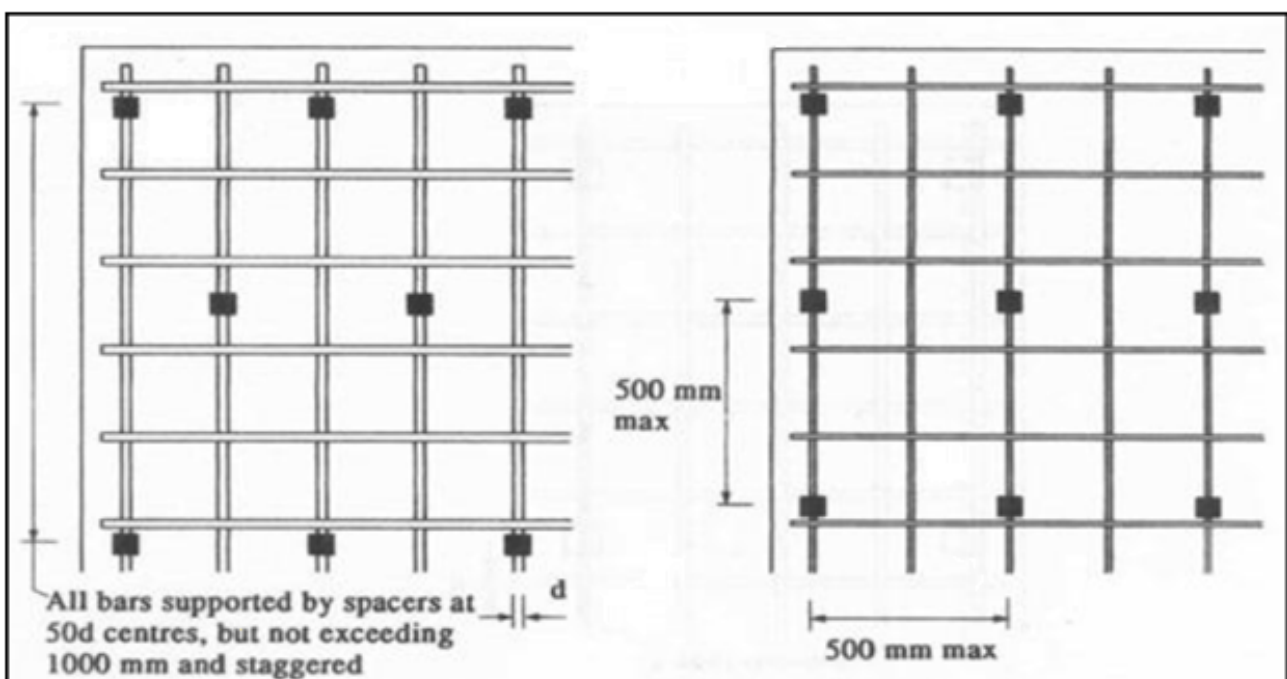

WHEEL SPACING IN COLUMN CONSTRUCTION (d = bar diameter)

Spacers to be fixed vertically to links at top, middle and bottom of each lift, at centers not exceeding $100 \times d$.

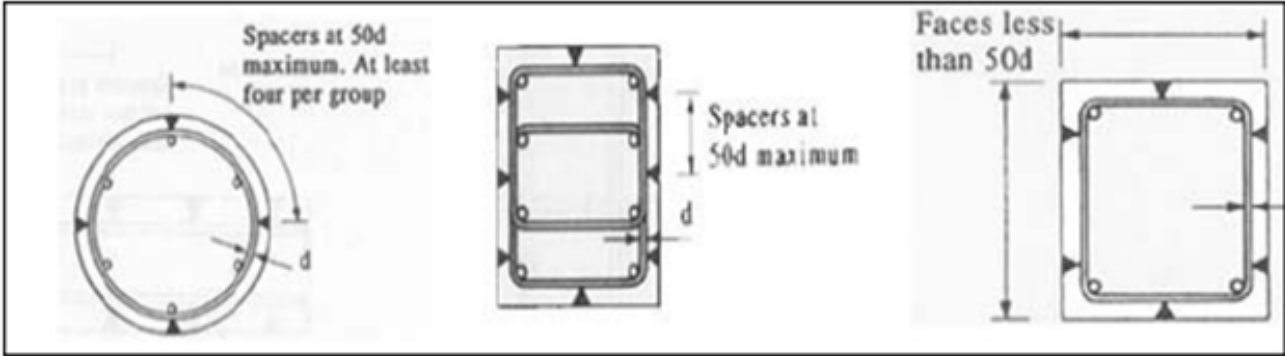

Wheel Spacer (MW)

Wheel Spacer was designed to use in vertical and horizontal reinforcements and it gives the required distance between formwork and rebar.



Product Code	Item Description	Concrete Cover(mm)	For Steel Diameter	Packing Quantity per Bag(pcs)
N-MW20	Wheel Spacer MW 20	20	4-13	1000
N-MW25	Wheel Spacer MW 25	25	4-16	1000
N-MW30	Wheel Spacer MW 30	30	4-20	500
N-MW40	Wheel Spacer MW 40	40	4-20	250
N-MW50	Wheel Spacer MW 50	50	4-22	250
N-MW60	Wheel Spacer MW 60	60	8-32	150
N-MW65	Wheel Spacer MW 65	65	8-32	150
N-MW75	Wheel Spacer MW 75	75	8-32	100
N-MW100	Wheel Spacer MW 100	100	8-32	50

Modern Universal Spacer (MUS)

Universal wheel spacer (MUS) is the most extensively used circular spacer for precast and on-site concrete applications. Wide contact surface and foot members increase load capacity and prevent tipping

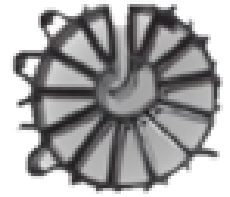

Product Code	Item Description	Concrete Cover(mm)	For Steel Diameter	Packing Quantity per Bag(pcs)
N-MUS20	Modern Universal Spacer 20	20	4-12	2000
N-MUS25	Modern Universal Spacer 25	25	4-12	1000
N-MUS30	Modern Universal Spacer 30	30	4-12	1000
N-MUS40	Modern Universal Spacer 40	40	6-20	500
N-MUS50	Modern Universal Spacer 50	50	6-20	500

4 Legs Chair Spacer (4LCS)

The 4 Leg Chair Spacer is suggested for all kinds of slabs, on site casting, prefabricated, tilt ups, post tension and concrete finish. (Comes in various colors)



Product Code	Item Description	Concrete Cover(mm)	Packing Quantity per Bag(pcs)
N-4LCS20	4 Leg Chair Spacer 20	20	500
N-4LCS25	4 Leg Chair Spacer 25	25	500
N-4LCS30	4 Leg Chair Spacer 30	30	500
N-4LCS40	4 Leg Chair Spacer 40	40	500
N-4LCS50	4 Leg Chair Spacer 50	50	500

Clip Spacer (MC)

A medium plastic chair spacer, designed for supporting a minimum load of 100kg according to German performance class 12 (1KN). The clips spacers can be used for various applications in horizontal positions in pre-cast or inside concrete



Recommended installation 50cm interval.

Product Code	Item Description	Concrete Cover(mm)	For Steel Bar Diameter (mm)	Packing Quantity per Bag (pcs)
N-MC20	Clip Spacer MC 20	20	4-16	2000
N-MC25	Clip Spacer MC 25	25	4-20	1000
N-MC30	Clip Spacer MC 30	30	4-20	1000
N-MC40	Clip Spacer MC 40	40	4-20	500
N-MC50	Clip Spacer MC 50	50	4-20	500
N-MC75	Clip Spacer MC 75	75	10-32	250

Normfix Spacer (NFC)

The wide stands prevent the tipping of the element usage area ranges from radial foundation to heavy duty lying and beams. The durability of our Normfix is undeniable



Product Code	Item Description	Concrete Cover(mm)	For Steel Bar Diameter (mm)	Packing Quantity per Bag (pcs)
N-MW25	Normfix H/D Spacer 25	25	8-24	500
N-MW30	Normfix H/D Spacer 30	30	8-24	500
N-MW40	Normfix H/D Spacer 40	40	8-24	500
N-MW50	Normfix H/D Spacer 50	50	8-24	250
N-MW60	Normfix H/D Spacer 60	60	16-36	200
N-MW65	Normfix H/D Spacer 65	65	16-36	200
N-MW75	Normfix H/D Spacer 75	75	16-36	150
N-MW100	Normfix H/D Spacer 100	100	16-36	150

Clampfix Chair Spacer (MCL)

Clampfix is a sturdy general purpose clip-on spacer used on all types of applications, found in precast yards and on site



Product Code	Item Description	Concrete Cover(mm)	For Steel Bar Diameter (mm)	Packing Quantity per Bag (pcs)
N-MCL20	Clampfix M/D chair spacer 20	20	4-16	2000
N-MCL25	Clampfix M/D chair spacer 25	25	4-20	1000
N-MCL30	Clampfix M/D chair spacer 30	30	4-20	1000
N-MCL40	Clampfix M/D chair spacer 40	40	4-20	500
N-MCL50	Clampfix M/D chair spacer 50	50	4-20	500
N-MCL75	Clampfix M/D chair spacer 75	75	10-32	250

NMG NIPRAS
METAL GROUP

شركة مجموعة نبراس المعادن المحدودة
NIPRAS METAL GROUP COMPANY Ltd.

Contact Us:

 Tel : +966 570998080

 info@nipras.sa

 www.nipras.sa

 6353 Al Musafat area P.O
Box:236300 Al Riyadh 14543.

